





PROJECT		REF		REV	ITEM CODE	
LOCATION		DATE			PAGE	

**SANITARY WARE SPECIFICATION SHEET**

<p><b>Item Descriptions</b></p> <p><b>Dimensions</b></p> <p><b>Model</b></p> <p><b>Material</b></p> <p><b>Finish</b></p> <p><b>Manufacturer</b></p> <p><b>Source</b></p> <p><b>Contact Tel/Fax</b></p> <p><b>E-mail</b></p> <p><b>Website</b></p>	<p>American Standard (PRC) Stainless steel in grade 304 one-bowl sink</p> <p>L800 x W480 x H210 mm (Bowl)</p> <p>101369MS00</p> <p>Stainless Steel 304</p> <p>Satin</p> <p>American Standard (PRC)</p> <p>Acme Sanitary Ware Co. Ltd Mr. Eric Wong/ Mr. Don Yuen</p> <p>(852) 2388-7171 / (852) 2710-8012</p> <p>acme@acmesanitary.com.hk</p> <p>www.acmesanitary.com.hk</p>	<p align="center"><b>Illustration/ Drawing</b></p>   
<p><b><u>Detail specifications</u></b></p> <ul style="list-style-type: none"> <li>Top/Under Counter Handmade One-bowl Sink</li> <li>High Quality SUS304 Stainless Steel</li> <li>Strong Ability for Anti-corrosion and Anti-oxidation</li> <li>Handmade Process and High-end Satin Finish</li> <li>Rearward- waste design</li> <li>Capacity (to overflow): 35L</li> <li>With SUS304 drain and PP Material Waste</li> <li>SUS304 Sheet Thickness 2.0mm (Panel) / 1.0 (Body)</li> <li>With box packaging / Product weight: 10.9kg</li> <li>Standards Criteria: Q/ASJM 004-2023</li> </ul>		

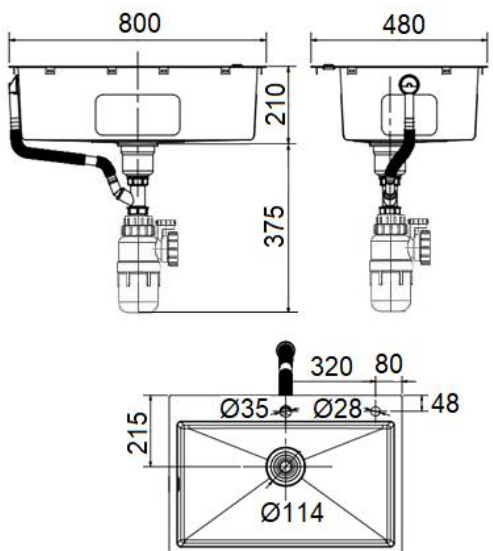
Note: Bottle trap is excluded.

\* All information of the above is for the reference only. No prior notice is made if any changes.



## SANITARY WARE SPECIFICATION SHEET

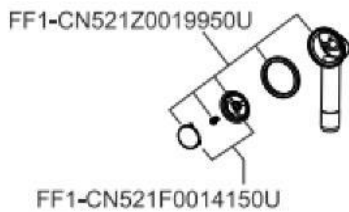
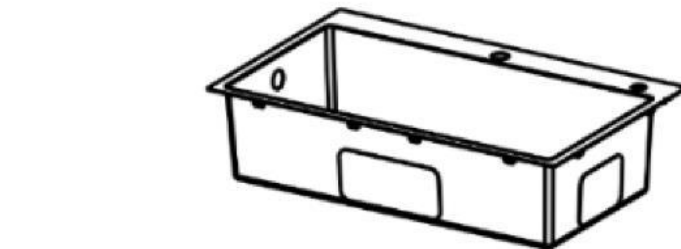
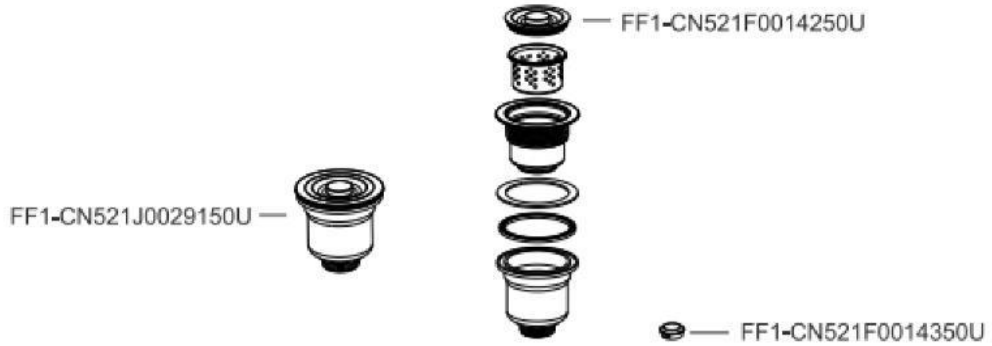

Compatible with 1/2" anti-siphonic bottle trap  
(Bottle trap shall be bought separately)

Note: Bottle trap is excluded.